

AVAILABLE FOR LEASE

1331-1333 DAVIS ROAD, ELGIN, ILLINOIS



BUILDING SPECIFICATIONS

BUILDING SIZE:	125,900 SF
AVAILABLE SPACE:	42,521 SF
OFFICE:	5,880 SF
CEILING HEIGHT:	18' clear
LOADING:	2 interior docks 2 drive-in doors
PARKING:	90 cars
POWER:	1200 amps; 277/480 volt 3-phase; 4-wire
SPRINKLER:	Yes
REAL ESTATE TAXES:	\$1.26 psf
LEASE RATE:	\$4.50 net psf

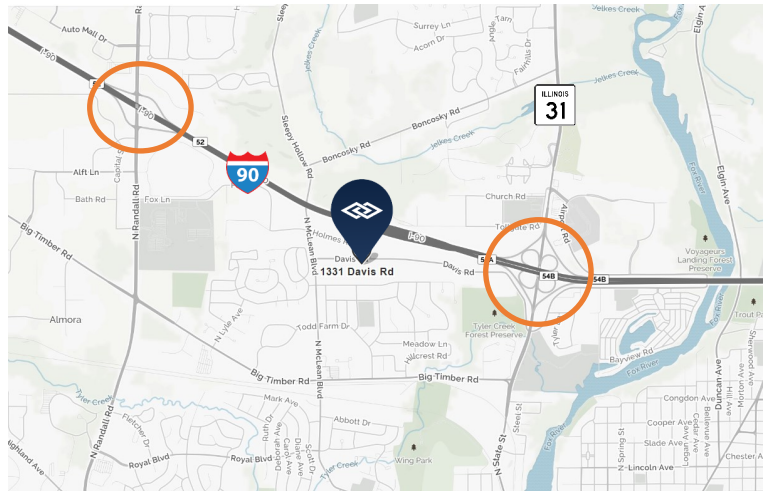

FEATURES

- Immediate access to I-90 at Randall Road and Route 31
- Low Kane County real estate taxes
- Institutionally owned and managed by Zilber Property Group

**FOR ADDITIONAL
INFORMATION,
PLEASE CONTACT:**

NOEL S. LISTON
Principal
nliston@darwinrealty.com

BRENDAN J. SHEAHAN
Vice President
bsheahan@darwinrealty.com

AVAILABLE FOR LEASE

1331-1333 DAVIS ROAD, ELGIN, ILLINOIS

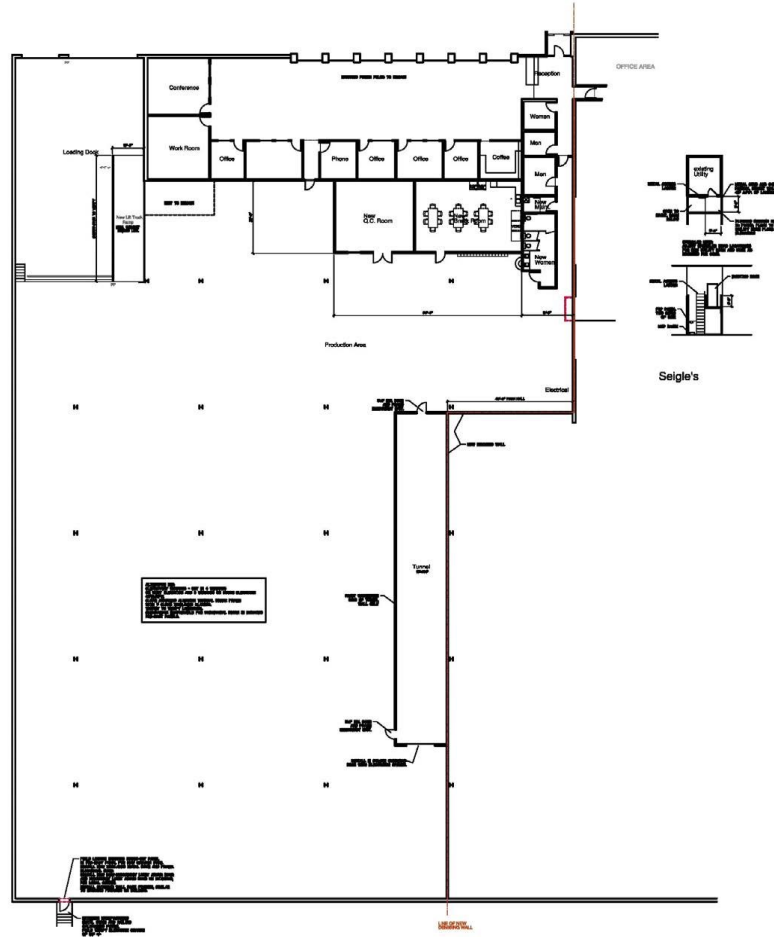

**FOR ADDITIONAL
INFORMATION,
PLEASE CONTACT:**

NOEL S. LISTON
Principal
nliston@darwinrealty.com

BRENDAN J. SHEAHAN
Vice President
bsheahan@darwinrealty.com