

2440 W. CORPORATE PRESERVE DRIVE
South Branch Industrial Park
Oak Creek, WI

ZILBER
PROPERTY GROUPSM

AVAILABLE



BUILDING INFORMATION

Available Space	30,000 SF
Building Size	68,700 SF
Office	5,000 SF
Clear Height	24'-0"
Car Parking	153 Spaces Total
Loading	4 Docks 1 Drive-In Door 7 Additional Trailer Stalls
Bay Size	50'-0" x 50'-0" (Typical)
Fire Protection	ESFR
Lighting	Energy Efficient, High Bay Fluorescent Fixtures (T-5)
Construction	Pre-Cast Panel

AREA INFORMATION

Located in Oak Creek's South Branch Industrial Park, 2440 W. Corporate Preserve Drive offers institutional-quality space, strategic access to major logistics corridor, I-94, and close proximity to various area amenities.

ADDITIONAL INFORMATION

- Access to I-94 via Ryan Road & Elm Road Interchanges
- Access to metro Milwaukee and Racine County skilled and unskilled work force
- Local, professional ownership and property management

TRAVEL TIMES

- 10 minutes to Milwaukee Mitchell International Airport
- 15 minutes to Zoo Interchange (I-41 & I-94)
- 20 minutes to downtown Milwaukee
- 25 minutes to Wisconsin/Illinois border
- 60 minutes to O'Hare International Airport

CONTACT US

ZILBER PROPERTY GROUP
710 N. Plankinton Avenue | Milwaukee, WI 53203
(414) 274-2623 | www.zilberpropertygroup.com

MICHAEL KLEBER
Director of Industrial Leasing
Michael.Kleber@Zilber.com | (414) 274-2628

AVAILABLE

FLOOR PLAN

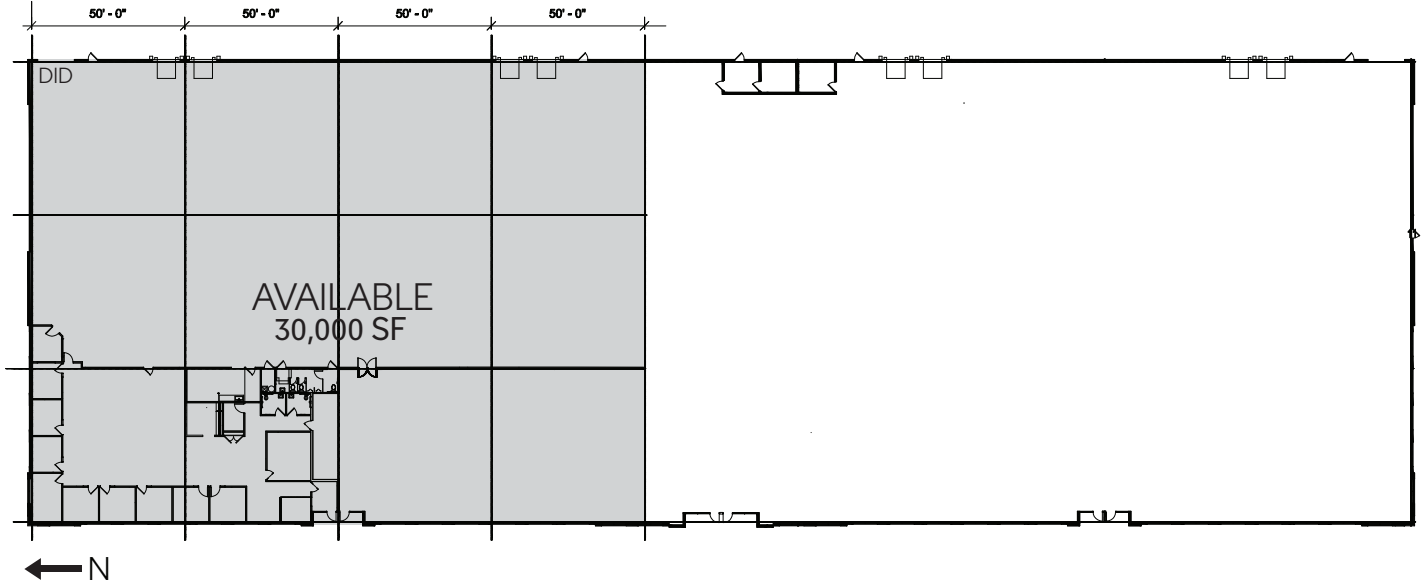

LOCATION MAP

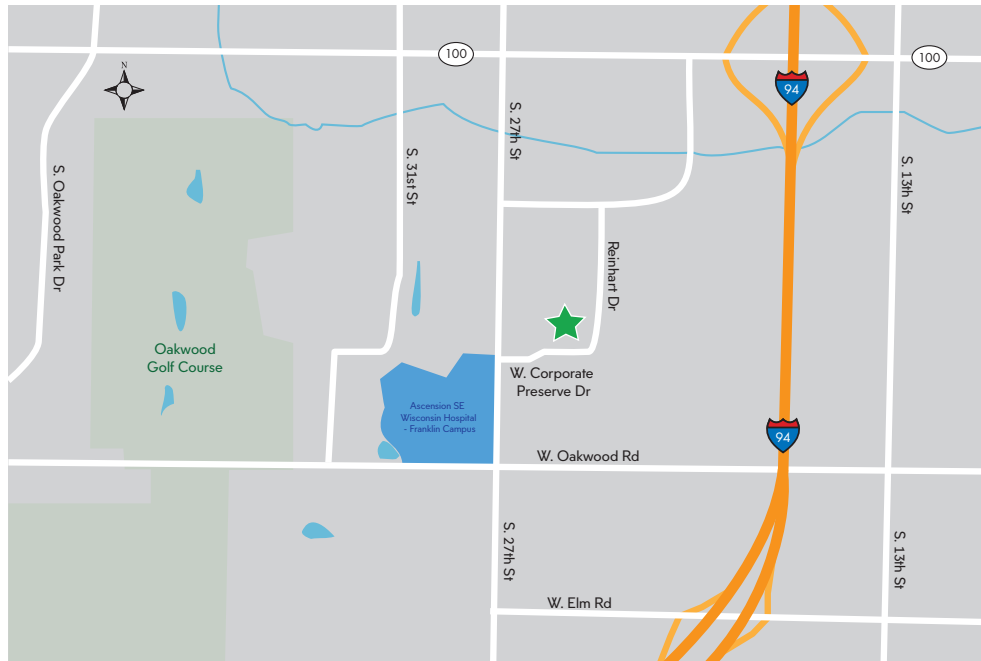

CONTACT US

ZILBER PROPERTY GROUP
 710 N. Plankinton Avenue | Milwaukee, WI 53203
 (414) 274-2623 | www.zilberpropertygroup.com

MICHAEL KLEBER
 Director of Industrial Leasing
Michael.Kleber@Zilber.com | (414) 274-2628